



Zero Gravity Operating Instructions

Thanks for your purchase of the Zero Gravity, the first fluid head of its kind designed specifically for DV and HD cameras. The ZG head enables the camera's Center of Gravity (CG) to be accurately positioned on the tilt axis, avoiding the balance problems associated with conventional tripod heads. The ZG will move effortlessly with fluid precision, but you need to read the instructions to ensure proper setup and operation

- Professional 100mm / 75mm mount
- Fluid, CG-adjustable head
- 360° rotation for greater tilt range than conventional heads*
- Dial marks enable precise, repeatable motions
- Dual independent pan and tilt handles for stable, accurate control
- Compatible with cameras up to 15lbs.

Assembly:

To mount the Zero Gravity to your tripod, simply unscrew the knob located on its underside, place the ZG into the tripod bowl, and then refasten the knob. A spirit level on the base enables accurate leveling of the ZG. Once the head is level, tighten the knob thoroughly. Attach pan and tilt handles and adjust to the desired length and positions.



Mounting and Balancing the Camera:

Looking at the camera platform (pictured at right), choose the appropriate camera-mounting screw and place the camera as close to the tilt arm as possible (reposition the screw in different slots, as necessary). Tighten the screw to secure the camera, but you may have to loosen it again for the *horizontal balancing procedure*:



Horizontal Balance: Position and extend the tilt handlebar (pictured at right) to the desired angle and length, then fix all accessories, viewfinder, loose cables, etc., in the exact position you will use them before balancing. Make sure the 'Drag/Lock' tilt knob is completely loosened. Move the camera forward or backward until it remains completely level (i.e., no tilting up or down on its own). Once it is balanced, tighten the camera screw thoroughly.

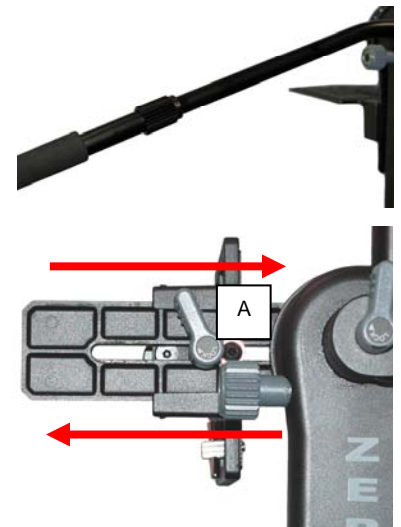

Vertical Balance: Make sure the 'Drag/Lock' tilt knob is completely loosened. Point the camera straight up (or straight down) and see if it stays vertical. If the camera drifts downward, raise the camera mounting platform (you'll have to loosen the 'Lock' L-knob (A) to slide the platform). If it drifts upward, lower the platform. Tweak the position of the platform until the camera remains perfectly vertical.

Cross-Check Balance: With perfect horizontal AND vertical balance, you should be able to tilt the camera at any angle, let go of the handle, and the camera should stay in position. To cross-check the balance, tilt the camera at 45° intervals all the way around. If it moves on its own, tweak the vertical and/or horizontal balance until it remains in place at any tilt angle.

NOTE: With heavier cameras, you can compensate for any visible downward flexing of the camera platform by tightening the round knurled knob located directly below the platform (in order to do this, you the 'Lock' L-knob must be loose – see (A) on previous page).

Operation:

You can adjust the position of the main vertical support arm by loosening the knob on the underside (B) and sliding the arm in or out. This adjustment is primarily a matter of personal preference, although you may get the best results by centering the camera directly over the pan axis (above the spirit level).

Adjust the *Drag/Lock* knobs to your preferred level of resistance for pan and tilt motions. It is not *necessary* to apply any drag, but you should play with it to see what works best. The unit can be operated with just the tilt handle, or for maximum control, with both handles.

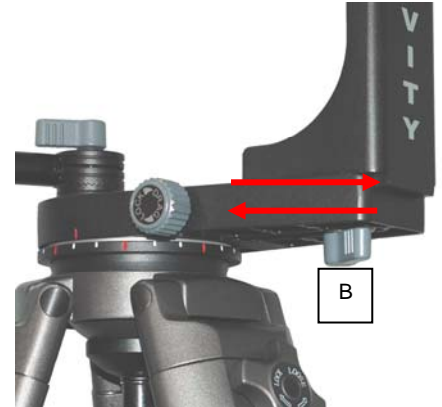

Underslung Operation:

The Zero Gravity can also be used as a manual pan/tilt head on a crane. Once you have secured the ZG head to your crane, balance the unit in the manner previously described in these instructions

Always exercise caution when using a crane. Avoid power lines and windy conditions, and make sure all fasteners, cables, tripod, and other load-bearing elements are completely secure to avoid potentially dangerous falls.



VariZoom
www.varizoom.com

888-826-3399



* long lenses on large cameras may inhibit 360° tilting due to clearance

The Zero Gravity fluid head is covered by a one-year warranty (parts/labor). Please retain your receipt for warranty verification. All returns and repairs must be accompanied by a Return Merchandise Authorization number (RMA #) issued by the VariZoom Service Department

Warnings: Disassembling the unit or exceeding the recommended weight capacity may void the warranty.